

LiteBanner (Sizes 23", 33", 39", 47")

* Telescopic pole min. height: 60"

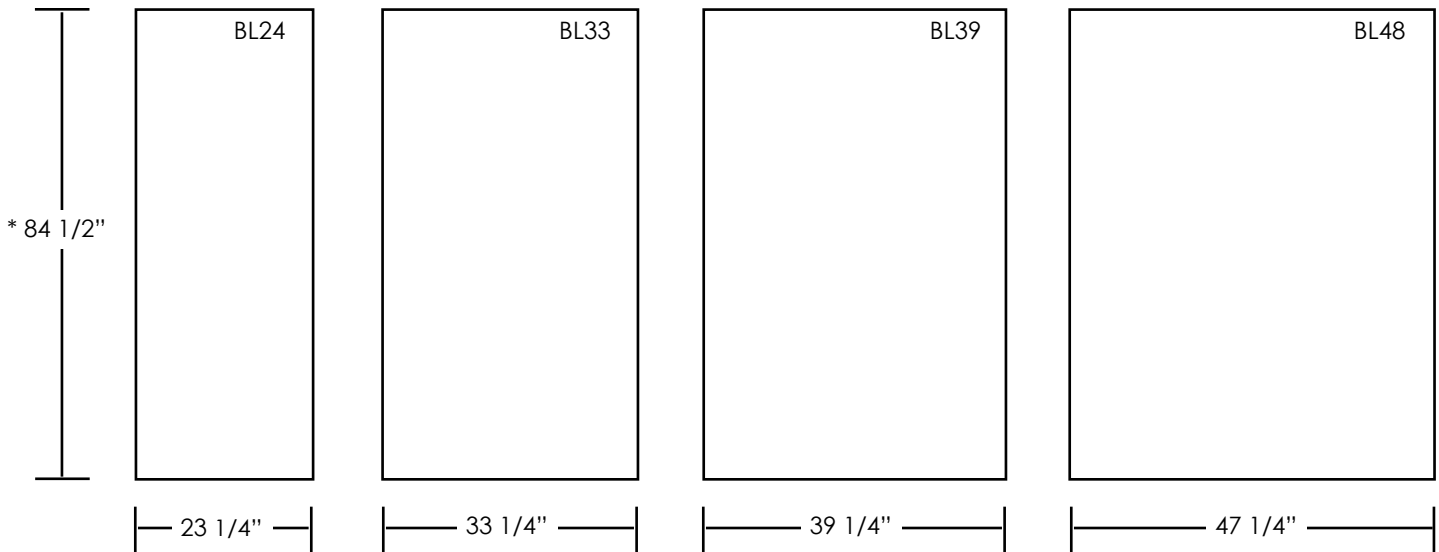

Indoor X-Ban (Size 31")

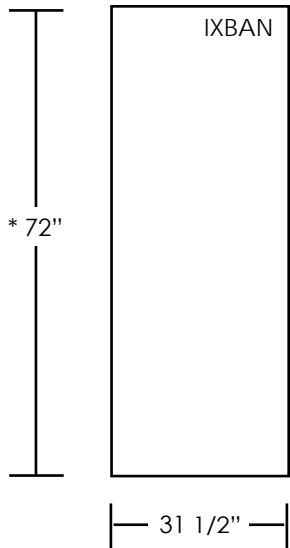

* Min. height: 66"

Tripod (Size 39" max. x 108" max.)

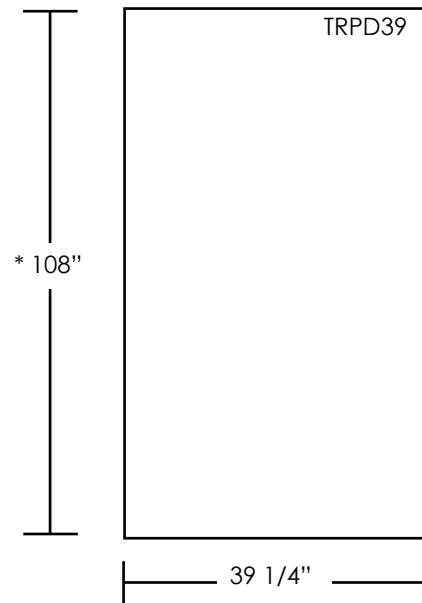

* Telescopic pole min. height: 40"

Send artwork via
CD-ROM, DVD, FTP

Graphic specifications

Use CMYK color profile.

Tiff files without layers are preferred. High-resolution .pdf, .ai or .psd files are also accepted.

Supply all fonts or convert text to outlines if supplying .ai or .psd files.

Artwork should be a minimum of 100 dpi at 100% print size.

If color matching is critical, please provide us with specific PMS colors or a spot color. Additional color matching charges may apply.

Color matching can not be guaranteed.

Bamboo LiteBanner (Size 31")

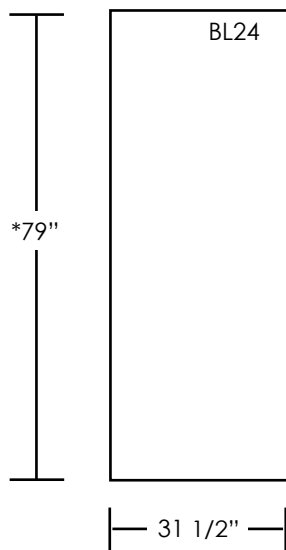

Beacon

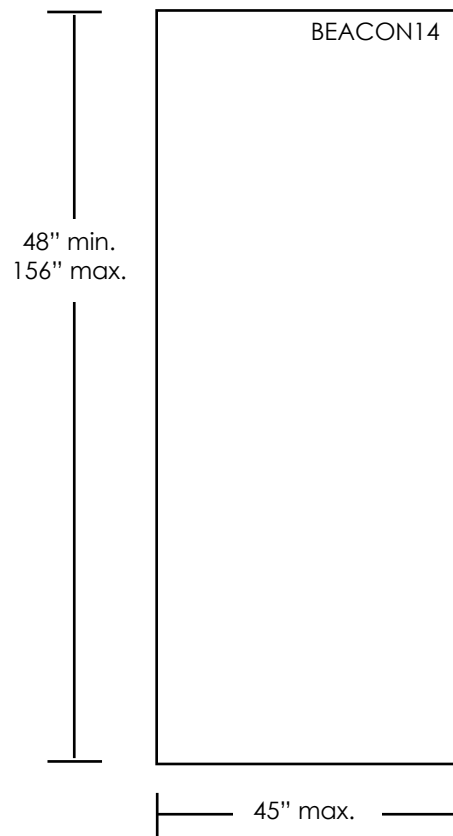

Scrolling Banner

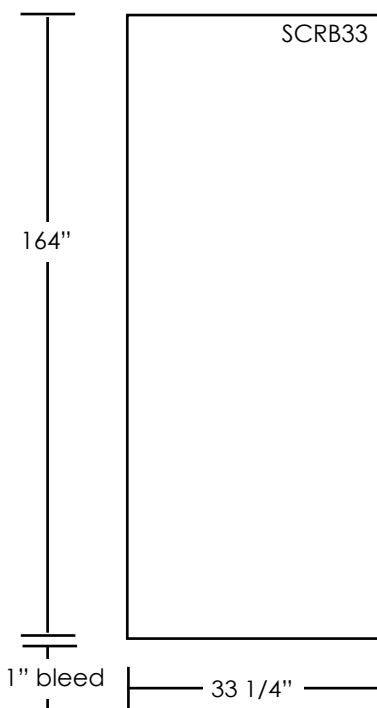

Add 1" bottom bleed for Scrolling Banner

Outdoor X-Ban

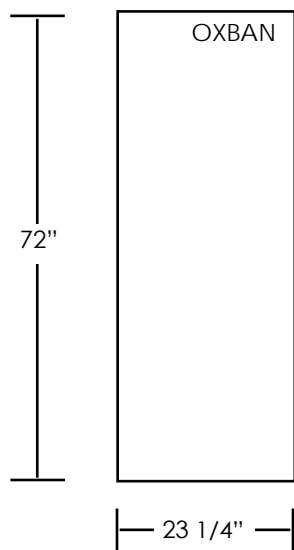

NB: No extra bottom bleed necessary for Bamboo LiteBanner, Outdoor X-Ban and Beacon banner stands

Send artwork via
CD-ROM, DVD, FTP

Graphic specifications

Use CMYK color profile.

Tiff files without layers are preferred. High-resolution .pdf, .ai or .psd files are also accepted.

Supply all fonts or convert text to outlines if supplying .ai or .psd files.

Artwork should be a minimum of 100 dpi at 100% print size.

If color matching is critical, please provide us with specific PMS colors or a spot color. Additional color matching charges may apply.

Color matching can not be guaranteed.